

# Toroidal Current Transformers With mA or Voltage Output

Yuanxing CTT0 series CTs are indoor used, seven window sizes and various turn ratios are optional.



## FEATURES

- Low cost
- Wound cold rolling oriented silicon steel core, without air gap, uniform wound secondary winding, small flux leakage
- Seven CT sizes
- Secondary output mA or mV/V.

## APPLICATION

- Current, power, energy monitoring devices
- Relay protection devices

## SPECIFICATIONS

- Case material: ABS or PBT resin.
- Frequency: 50-400 Hz
- Working temperature: -40°C - +85° C
- Working voltage: 600Vac,
- Dielectric strength: 2500V /min
- Surge voltage: 5000V(1.2/50μs standard lightning impulse)
- RoHS complied
- CE complied
- Accuracy class: IEC60044-1, Class 0.1, 0.2, 0.5
- Safety requirement: Secondary winding is not allowed to work open circuit.

## PARAMETERS

Series	Rated Input Current (A)	Ratio	Accuracy Class	Outline Dimensions (mm)					
				A	L	W	H	D	G
CTT0150	20,50,75,80, 100,125,150	1000:1 2000:1 3000:1 4000:1 5000:1	0.1,0.2	15	58	23	45	49	4
CTT0200	30,50,75,80, 100,125,150		0.2,0.5	20	68	20	58	58.3	4
CTT0250	50,75,100, 150,200,250		0.2,0.5	25	80	23	69.5	68	6
CTT0350	75,100,200, 300,400,500		0.2,0.5	35	100	30	90	85.5	6.5
CTT0450	100,200,300, 400,500,600		0.2,0.5	45	120	34	101.5	98	5
CTT0550	150,200,300, 500, 750,800		0.2,0.5	55	150	36	126	126	5.5
CTT0720	200,300,500, 750,800,1000		0.2,0.5	72	125	30	137.5	105	8.5

Note: Optional secondary voltage output 0.1V~5VAC.

## DEFINITION

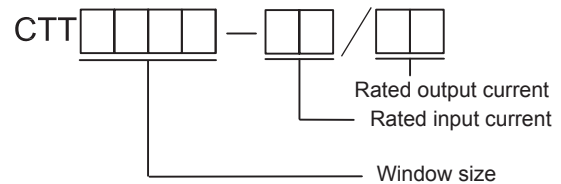

## OUTLINE DIMENSIONS

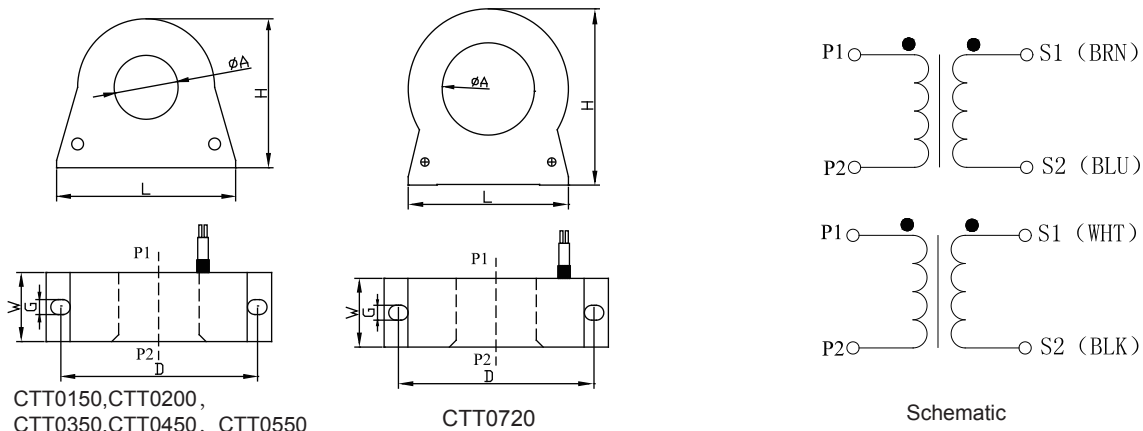

CTT0150,CTT0200,  
CTT0350,CTT0450, CTT0550

CTT0720

Schematic

**SHANDONG YUANXING Electronics Co.,Ltd.**

Phone: +86-533-381-8450  
Fax: +86-533-381-8724

NO.39, QIXIN AVENUE, ZHANGDIAN,  
ZIBO, SHANDONG, CHINA 255095

[www.yuanxing.net](http://www.yuanxing.net)  
[sales@yuanxing.net](mailto:sales@yuanxing.net)